

Technical sheet No 132GM/KAR

1. Supplier name: **GÓRALMET Sp. z o.o.**

Supplier address: **ul. Krakowska 68, 32-860 Czchów, tel/fax 014 6635260**

2. Product name: **C2 galvanized long link chain**

3. Description and use: Electric welded round long link chains, designed for use in agriculture and the other general applications. For use within technical parameters given in point 5.

4. C2 long link chains cannot be used in the applications that has safety requirements regulated by law or standards, for example for lifting. Do not overload over WLL (kG) given in column 7.

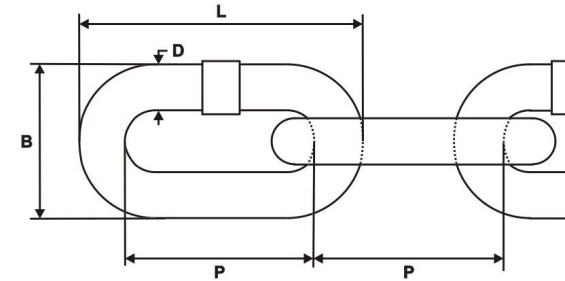

5. Technical parameters:

No	Size D [mm]	Nominal dimensions [mm]			Weight [kg/pc]	WLL Working load [kG]	BF Breaking force [min. kG]	Material	Coatings
		L	P	B					
1	2	3	4	5	6	7	8	9	10
1	2	27	23	8,5	0,060	7	28	C10 ~ C15	Electro-galvanized
2	3	32,5	26,5	12	0,138	40	160		
3	4	40	32,5	16	0,243	80	320		
4	5	45	35	19	0,392	125	500		
5	6	54	42	23	0,575	160	640		
6	7	63,5	50	28	0,821	220	880		
7	8	67,5	52	29	0,969	320	1280		
8	10	84	65	41	1,586	500	2000		

6. Additional informations:

- Safety factor -4,
- $BF = 4,0 \times WLL$
- Additional informations – label: product name; size; quantity; order No; manufacturer's data and website address.