

## Technical sheet No 20GM/KAR

1. Supplier name: **GÓRALMET Sp. z o.o.**

Supplier address: **ul. Krakowska 68, 32-860 Czchów, tel/fax 014 6635260**

2. Product name: **D1 galvanized short link chain 5685/A**

3. Description and use: Electric welded round short link chains, designed for use in agriculture and the other general applications. For use within technical parameters given in point 5.

4. D1 short link chains cannot be used in the applications that has safety requirements regulated by law or standards, for example for lifting. Do not overload over WLL (kG) given in column 7.

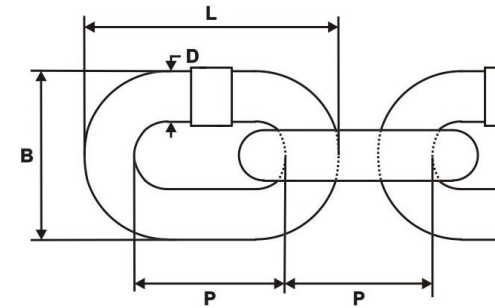

5. Technical parameters:

| No | Size D [mm] | Nominal dimensions [mm] |      |      | Weight [kg/PC] | WLL Working load [kG] | BF Breaking force [min. kG] | Material  | Coatings           |
|----|-------------|-------------------------|------|------|----------------|-----------------------|-----------------------------|-----------|--------------------|
|    |             | L                       | P    | B    |                |                       |                             |           |                    |
| 1  | 2           | 3                       | 4    | 5    | 6              | 7                     | 8                           | 9         | 10                 |
| 1  | <b>2</b>    | 16,5                    | 12   | 8    | 0,069          | 25                    | 125                         | C10 ~ C15 | Electro-galvanized |
| 2  | <b>3</b>    | 22                      | 16   | 11,5 | 0,161          | 56                    | 280                         |           |                    |
| 3  | <b>4</b>    | 28                      | 20,5 | 16   | 0,304          | 100                   | 500                         |           |                    |
| 4  | <b>5</b>    | 32                      | 22,5 | 19,5 | 0,457          | 160                   | 800                         |           |                    |
| 5  | <b>6</b>    | 36                      | 24   | 23   | 0,723          | 225                   | 1125                        |           |                    |
| 6  | <b>7</b>    | 42                      | 28   | 28   | 1,004          | 300                   | 1500                        |           |                    |
| 7  | <b>8</b>    | 48                      | 32,5 | 30   | 1,289          | 400                   | 2000                        |           |                    |
| 8  | <b>10</b>   | 59                      | 40   | 37   | 1,748          | 630                   | 3150                        |           |                    |

6. Additional informations:

- Safety factor -5,
- BF =5,0 x WLL
- Additional informations – label: product name; size; quantity; order No; manufacturer's data and website address.