

## Technical sheet No 21GM/KAR

1. Supplier name: **GÓRALMET Sp. z o.o.**

Supplier address: **ul. Krakowska 68, 32-860 Czchów, tel/fax 014 6635260**

2. Product name: **D2 galvanized long link chain 5685/C**

3. Description and use: Electric welded round long link chains, designed for use in agriculture and the other general applications. For use within technical parameters given in point 5.

4. D2 galvanized long link chains 5685/C cannot be used in the applications that has safety requirements regulated by law or standards, for example for lifting. Do not overload over WLL (kG) given in column 7.

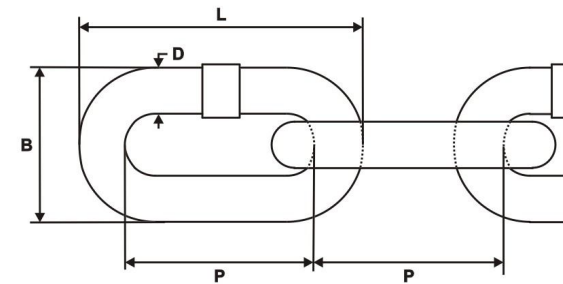

5. Technical parameters:

No	Size D [mm]	Nominal dimensions [mm]			Weight [kg/PC]	WLL Working load [kG]	BF Breaking force [min. kG]	Material	Coatings
		L	P	B					
1	2	3	4	5	6	7	8	9	10
1	<b>2</b>	26	22	8,5	0,062	25	125	C10 ~ C15	Electro-galvanized
2	<b>3</b>	33	27,5	12,5	0,158	56	280		
3	<b>4</b>	40	32	16	0,270	100	500		
4	<b>5</b>	45	35,5	20	0,405	160	800		
5	<b>6</b>	54	42,5	24,5	0,605	225	1125		
6	<b>7</b>	63	49	27	0,837	300	1500		
7	<b>8</b>	68,5	53	30,5	1,104	400	2000		
8	<b>10</b>	84,5	65,5	39	1,692	630	3150		

6. Additional informations:

- Safety factor -5,
- BF =5,0 x WLL
- Additional informations – label: product name; size; quantity; order No; manufacturer's data and website address.