

## Technical sheet No 136GM/KAR

1. Supplier name: **GÓRALMET Sp. z o.o.**

Supplier address: **ul. Krakowska 68, 32-860 Czchów, tel/fax 014 6635260**

2. Product name: **DIN1480 turnbuckle body**

3. Description and use: Forged tension nut with standard metric right-hand and left-hand thread, for use as tensioning device in general applications. For use within technical parameters given in point 5.

4. Do not overload over WLL (kG) given in column 13.

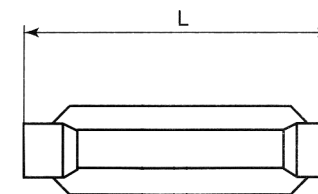

5. Technical parameters:

No	Size	Nominal dimensions [mm]									Weight [kg/pc]	WLL Working load [kG]	BF Breaking force [min. kG]	Material	Coatings
		L [mm]	---	---	---	---	---	---	---	---					
1	2	3	4	5	6	7	8	9	10	11	12	13	14	15	16
1	<b>M12</b>	125	---	---	---	---	---	---	---	---	0,186	950	2850	C10 ~ C15	Electro-galvanized
2	<b>M16</b>	170	---	---	---	---	---	---	---	---	0,420	1800	5400		
3	<b>M20</b>	200	---	---	---	---	---	---	---	---	0,728	2750	8250		
4	<b>M24</b>	255	---	---	---	---	---	---	---	---	1,258	4000	12000		
5	<b>M30</b>	255	---	---	---	---	---	---	---	---	1,731	6370	19110		

6. Additional informations:

- Safety factor - 3
- BF ≈ 3,0 x WLL
- Markings: manufacturer's symbol - GMG; size code; marking of side of left-hand thread - L
- Additional informations – label: product name; size; quantity; order No; manufacturer's data and website address.