

Technical sheet No 62GM/KAR

1. Issuer name: **GÓRALMET Sp. z o.o.** Issuer address: **ul. Krakowska 68, 32-860 Czchów, tel/fax 014 6635260**

2. Product name: **GM078-G8 Clevis self-locking hook with grip EN 1677-3**

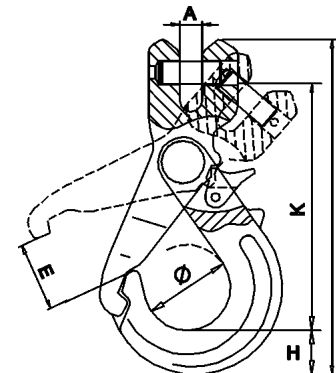



3. Description and use: Grade 8 forged steel self-locking hooks with clevis (type C) - for slings and lifting purposes. The locking mechanism capable to activate by the application of the load, which once properly closed and locked can be removed only after relief and deactivation of the locking mechanism. For use within technical parameters given in point 5 and the Directive 2006/42/EC
4. Working load limits are given for the normal working conditions. Usage in extreme conditions is not allowed without supplier agreement. Storage, installation and usage - according to instruction manual for lifting accessories.



5. Technical parameters:

No	Size [mm]	Nominal dimensions [mm]							Weight [kg/pc]	WLL Working load [t]	MPF Proof force [kN]	BF Breaking force [min. kN]	Material	Coatings	Product code No
		A	H	E	L	Ø	K	Pin [Ø mm]							
1	2	3	4	5	6	7	8	9	10	11	12	13	14	15	16
1	7/8	9,5	22	38,5	160	45	120	10,3	0,779	2	49	78,5	Grade 8 steel: Cr >= 0,40 % Ni >= 0,40 % Mo >= 0,15 % Al >= 0,025 % S <= 0,025 % P <= 0,025 %	Paint	7/8
2	10	12,5	30	46,5	202,5	55,5	149	13	1,503	3,15	77,2	124			10
3	13	15,5	39	51	241	62,5	171	17	2,728	5,3	130	208			13
4	16	19	46,5	59,5	288,5	78,5	206	20	4,406	8	196	314			16

6. Additional informations:

- Safety factor -4
- $MPF = 2,5 \times g \times WLL$, $BF = 4,0 \times g \times WLL$ where g - acceleration of gravity in m/s^2 (i.e. 9,80665)
- Manufacturer and product identification code: GM078
- Traceability code: a four-digit number by formula - YYMM (YY = year of production, MM = month of production)
- Markings: manufacturer's symbol –  or GMG; ; manufacturer and product identification code; traceability code; product code No; class No – 8; WLL....T
- Marking of bolts of 13 mm in diameter and larger:  or GMG; 8
- Additional informations – label: ; product name; product code No (size); WLL...T; quantity; order No; manufacturer's data and website address.