

## Technical sheet No 76GM/KAR

1. Supplier name: **GÓRALMET Sp. z o.o.**

Supplier address: **ul. Krakowska 68, 32-860 Czchów, tel/fax 014 6635260**

2. Product name: **Grade 8 technical chain**

3. Description and use: Grade 8 medium precision short link chains – 800 N/ mm<sup>2</sup> (MPa), for use as machinery equipment, also for use in agriculture, forestry and the other general applications within technical parameters given in point 5.

4. CAUTION – this product cannot be used for lifting, for the construction of slings or lashing chains used in the transport. For these purposes, should be used EN 818-2 grade 8 lifting chain.

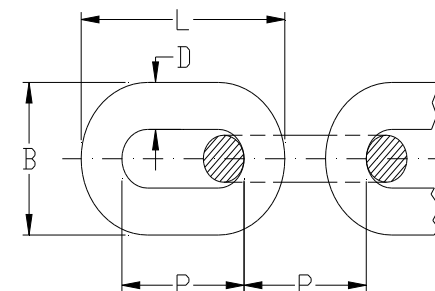

5. Technical parameters:

| No | Size<br>D [mm] | Dimensions [mm] |          |         | Weight<br>[kg/m] | WLL<br>Working<br>load [t] | MPF<br>Proof force<br>[kN] | BF<br>Breaking force<br>[min. kN] | Material            | Coatings | A <sub>≥</sub><br>[%] |
|----|----------------|-----------------|----------|---------|------------------|----------------------------|----------------------------|-----------------------------------|---------------------|----------|-----------------------|
|    |                | L [max]         | P        | B [max] |                  |                            |                            |                                   |                     |          |                       |
| 1  | 2              | 3               | 4        | 5       | 6                | 7                          | 8                          | 9                                 | 10                  | 11       | 12                    |
| 1  | 6 ± 0,24       | 30,5            | 18 ± 0,5 | 22,2    | 0,8              | 1,12                       | 28,3                       | 45,2                              | Grade 8 alloy steel | Paint    | 20                    |
| 2  | 7 ± 0,28       | 36,1            | 21 ± 0,6 | 25,9    | 1,1              | 1,5                        | 38,5                       | 61,6                              |                     |          | 20                    |
| 3  | 8 ± 0,32       | 40,7            | 24 ± 0,7 | 29,6    | 1,4              | 2                          | 50,3                       | 80,4                              |                     |          | 20                    |
| 4  | 10 ± 0,4       | 50,9            | 30 ± 0,9 | 37      | 2,2              | 3,15                       | 78,5                       | 126                               |                     |          | 20                    |
| 5  | 13 ± 0,52      | 66,2            | 39 ± 1,2 | 48,1    | 3,8              | 5,3                        | 133                        | 212                               |                     |          | 20                    |
| 6  | 16 ± 0,64      | 82,4            | 48 ± 1,4 | 59,2    | 5,7              | 8                          | 201                        | 322                               |                     |          | 20                    |

6. Additional informations:

- Safety factor -4,
- MPF=2,5 x g x WLL, BF =4,0 x g x WLL where g - acceleration of gravity in m/s<sup>2</sup> (i.e. 9,80665)
- Traceability code: B and a four-digit number by formula - YYMM (YY = year of production , MM = month of production)
- Markings (every 20-th link or every 1 meter): **8 ; GM**; traceability code
- Additional informations – label and tag: product name ; size; WLL(t)...; quantity; order No; manufacturer's data (website address).